



HORIZONTAL TYPE

QUICK CONNECTION

AIR TANK

SOLENOID VALVE

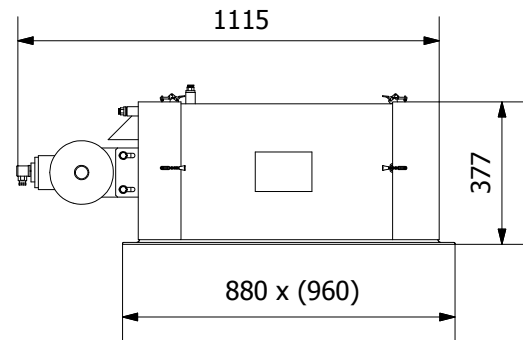
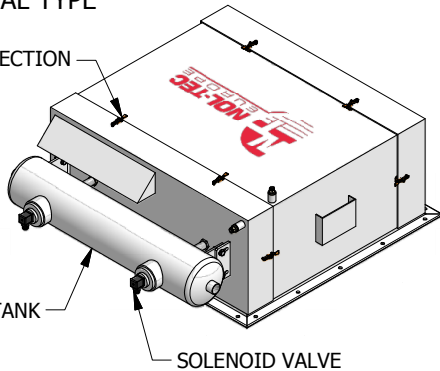

VERTICAL TYPE

SOLENOID VALVE

AIR TANK

DOOR FOR INSPECTION

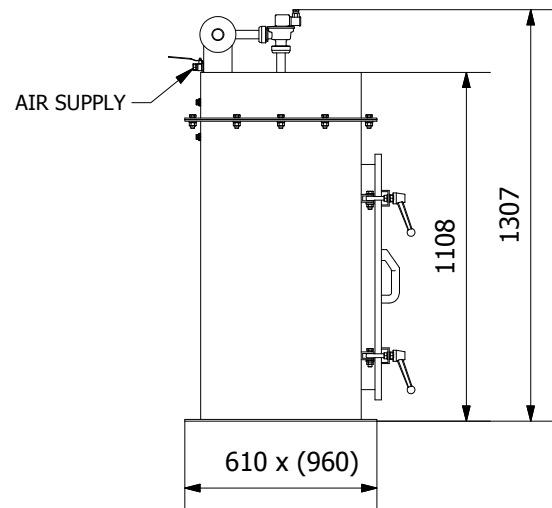
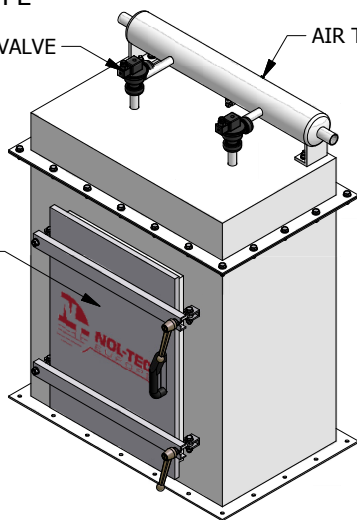

STANDARD FEATURES

- Compact design;
- 36 m² total filtering area;
- Reverse jet cleaning;
- Quick release filter cartridges;
- Access door for side cartridges removal (vertical type);
- Two access covers (horizontal type);
- Continuous welded construction.

SPECIFICATIONS

- Air:
 - Clean and dry at correct pressure dew point;
 - 6.5 bar minimum.
- Electrical: 24 Vcc 50 HZ
(OPTION 230 Vac - 50 Hz, 115 Vac)
(OPTION 60 Hz)
- Temperature: -10 °C to 120 °C (Process side)

OPTIONAL FEATURES

- ATEX design 94/9/CE; 
- Stainless construction AISI 304/316.
- Electronic timer;
- Variety of cartridges materials;
- Epoxy coatings;
- Differential pressure gauge.

The **NOL-TEC** compact dust collector is an effective method of filtering dust laden air generated by any process or pneumatic conveying systems where higher pressures are required.